

GENERAL ROAD MARKING IMPROVEMENTS

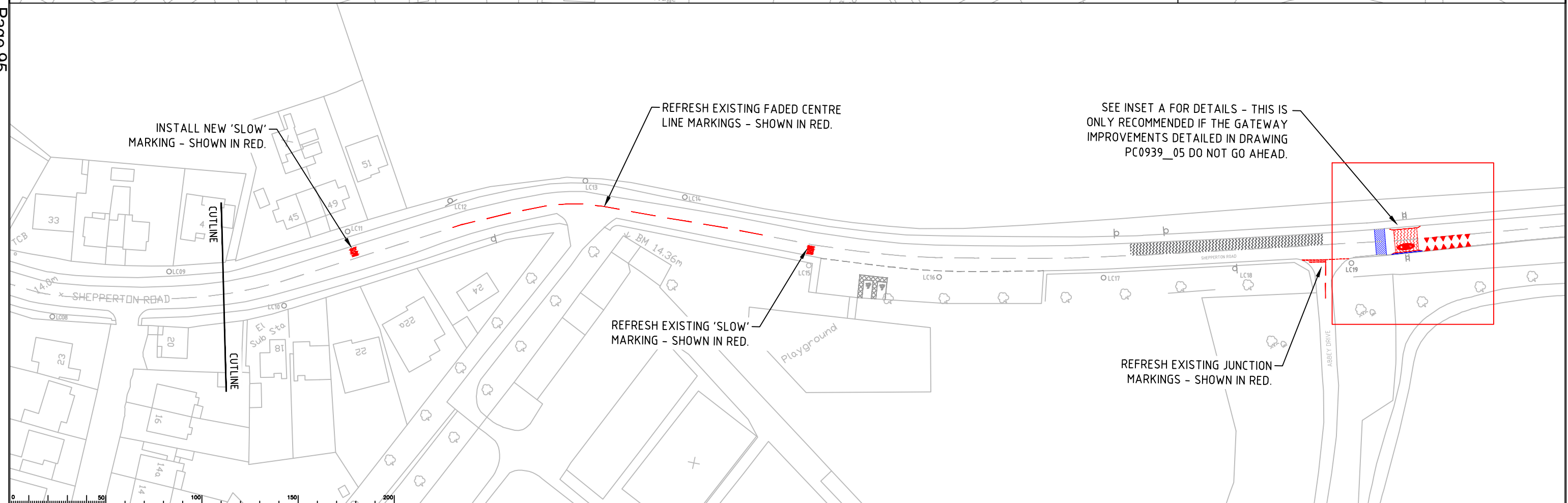
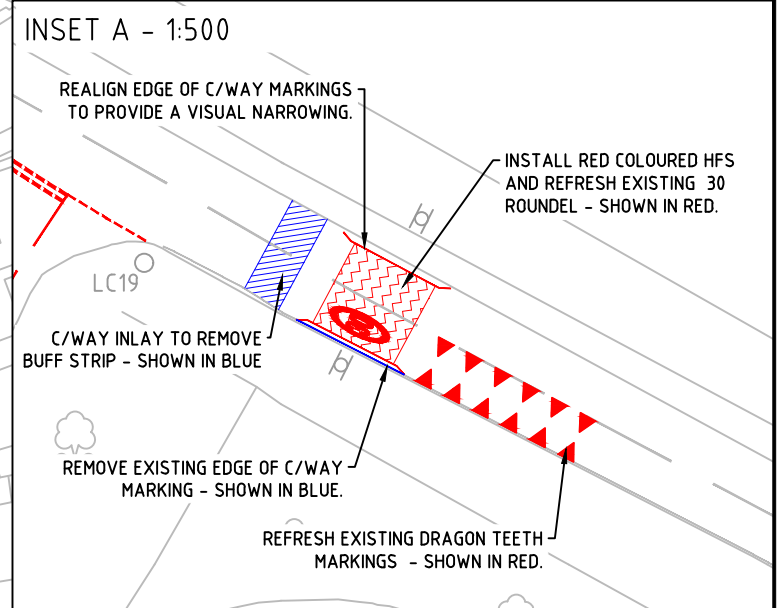
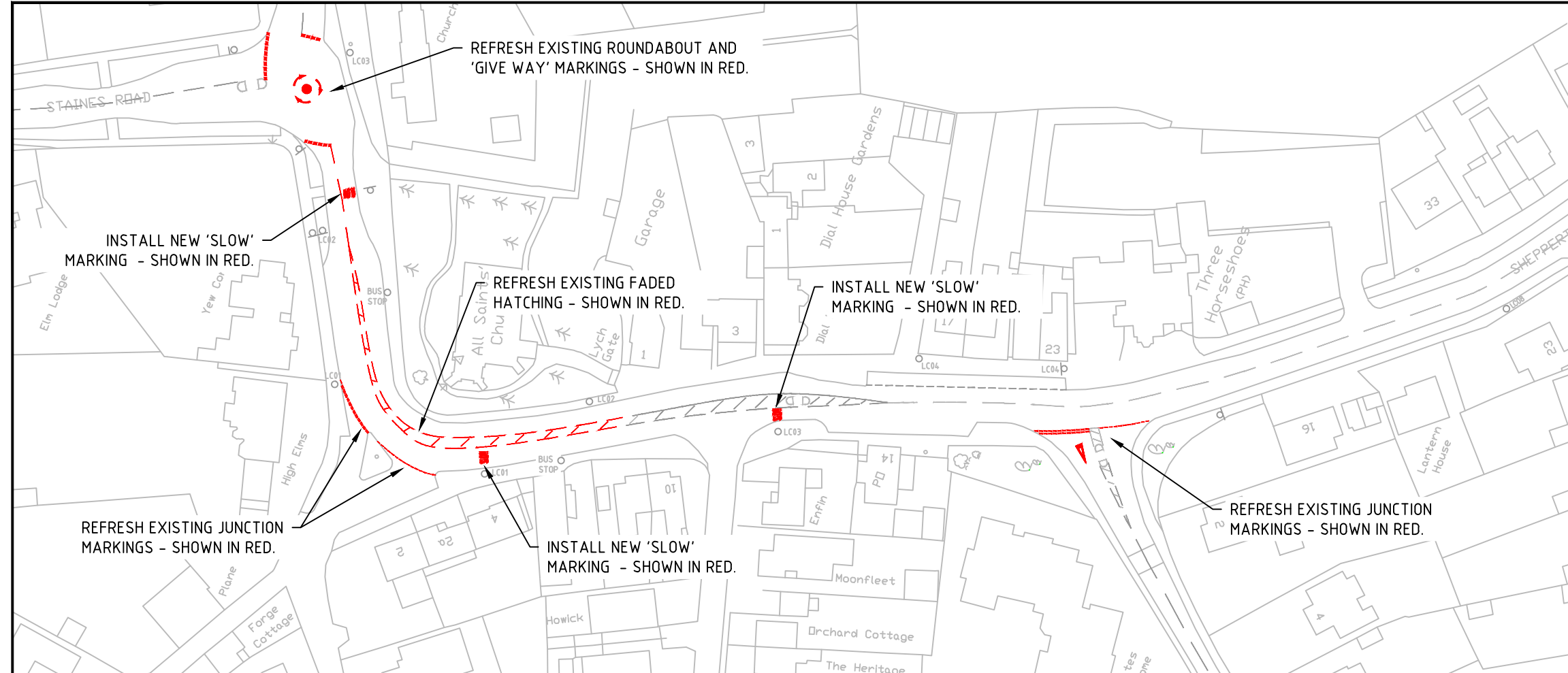

Page 95

Notes

Rev.	Description	Drwn	Sig.	Date	Chkd	Sig.	Date	Appr	Sig.	Date
A	Spelling correction	CHB	CHB	13.02.19	JD	JD	13.02.19			

Rev.	Description	Drwn	Sig.	Date	Chkd	Sig.	Date	Appr	Sig.	Date
A	Spelling correction	CHB	CHB	13.02.19	JD	JD	13.02.19			

North Point

Based upon the Ordnance Survey mapping with the permission of the Controller of Her Majesty's Stationery Office. Crown copyright. Unauthorised reproduction infringes Crown copyright and may lead to prosecution or civil proceedings. Surrey County Council LA 078872 2002.

Drawn by	Sig.	Date	Checked by	Sig.	Date	Approved by	Sig.	Date
CHB	CHB	JAN 19	JD	JD	JAN 19			

Project  
**LALEHAM VILLAGE FEASIBILITY SHEPPERTON ROAD**

Drawing  
**GENERAL ROAD MARKING IMPROVEMENTS**

SHEET 1 OF 1

Project No.  
**PC0939**

Contract Sheet No.  
**PC0939\_08**

Rev.  
**A**

Classification  
**PRESENTATION**

This page is intentionally left blank